

ELISE WAGNER
PARTNER
PHONE 212-715-9189
FAX 212-715-8208
EWAGNER@KRAMERLEVIN.COM

April 3, 2014

Via Hand Delivery

Hon. Meenakshi Srinivasan, Chair
New York City Board of Standards and Appeals
250 Broadway, 29th Floor
New York, NY 10007

Re: New York Methodist Hospital
Center for Community Health
505-525 6th Street (Block 1084, Lots 25, 26, 28,
39-44, 46, 48, 50-59, 164, 1001, and 1002)
BSA Cal. No. 289-13-BZ

Dear Chair Srinivasan:

We are writing on behalf of New York Methodist Hospital (the "Hospital") to inform the Board of certain design modifications that are being made to the referenced application for a variance for the proposed Center for Community Health (the "Center"). The Hospital has considered seriously both the comments made by the Board at its February 11, 2014, public hearing and the conditions set forth in the resolution of Brooklyn Community Board 6 with respect to the height and setback of the building in the R6B and R7B contextual zoning districts. The Hospital has determined that certain modifications, while challenging from a programmatic standpoint, can be achieved, and recognizes that these changes will allow the Center's design to be more in keeping with the essential character of the neighborhood. The Hospital proposes the following design modifications in response to these comments:

- The building's setback from 5th Street at the 6th floor in the R7B zoning district will be increased by 21 feet so as to achieve full compliance with applicable height and setback regulations in the R7B district;

1177 AVENUE OF THE AMERICAS NEW YORK NY 10036-2714 PHONE 212.715.9100 FAX 212.715.8000

990 MARSH ROAD MENLO PARK CA 94025-1949 PHONE 650.752.1700 FAX 650.752.1800

47 AVENUE HOCHÉ 75008 PARIS FRANCE PHONE (33-1) 44 09 46 00 FAX (33-1) 44 09 46 01

WWW.KRAMERLEVIN.COM

Hon. Meenakshi Srinivasan

April 3, 2014

Page 2

- The building's setback from 5th Street at the 4th floor in the R6B zoning district will be increased by an additional 15 feet, to a total depth of 20 feet from the property line; and
- The building's setback from 5th Street at the 5th through 7th floors in the R6B zoning district will be increased by additional 10 feet, to a total depth of 41 feet from the property line.

We will describe these design modifications in greater detail at the Board's public hearing on April 8, 2014, and will submit revised plans reflecting the modifications shortly thereafter.

Thank you for your continued consideration of the application.

Very truly yours,

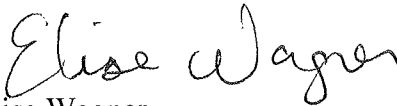
Elise Wagner

Enclosures

cc: Brooklyn Community Board 6
Hon. Eric Adams – Brooklyn Borough President
Hon. Brad Lander – City Council Member 39th District
Ira Gluckman, R.A. – Department of Buildings, Brooklyn
Purnima Kapur – Department of City Planning
Christopher Holme – Department of City Planning

1177 AVENUE OF THE AMERICAS NEW YORK NY 10036-2714 PHONE 212.715.9100 FAX 212.715.8000

990 MARSH ROAD MENLO PARK CA 94025-1949 PHONE 650.752.1700 FAX 650.752.1800

47 AVENUE HOCHÉ 75008 PARIS FRANCE PHONE (33-1) 44 09 46 00 FAX (33-1) 44 09 46 01

WWW.KRAMERLEVIN.COM

5TH STREET

8TH AVENUE

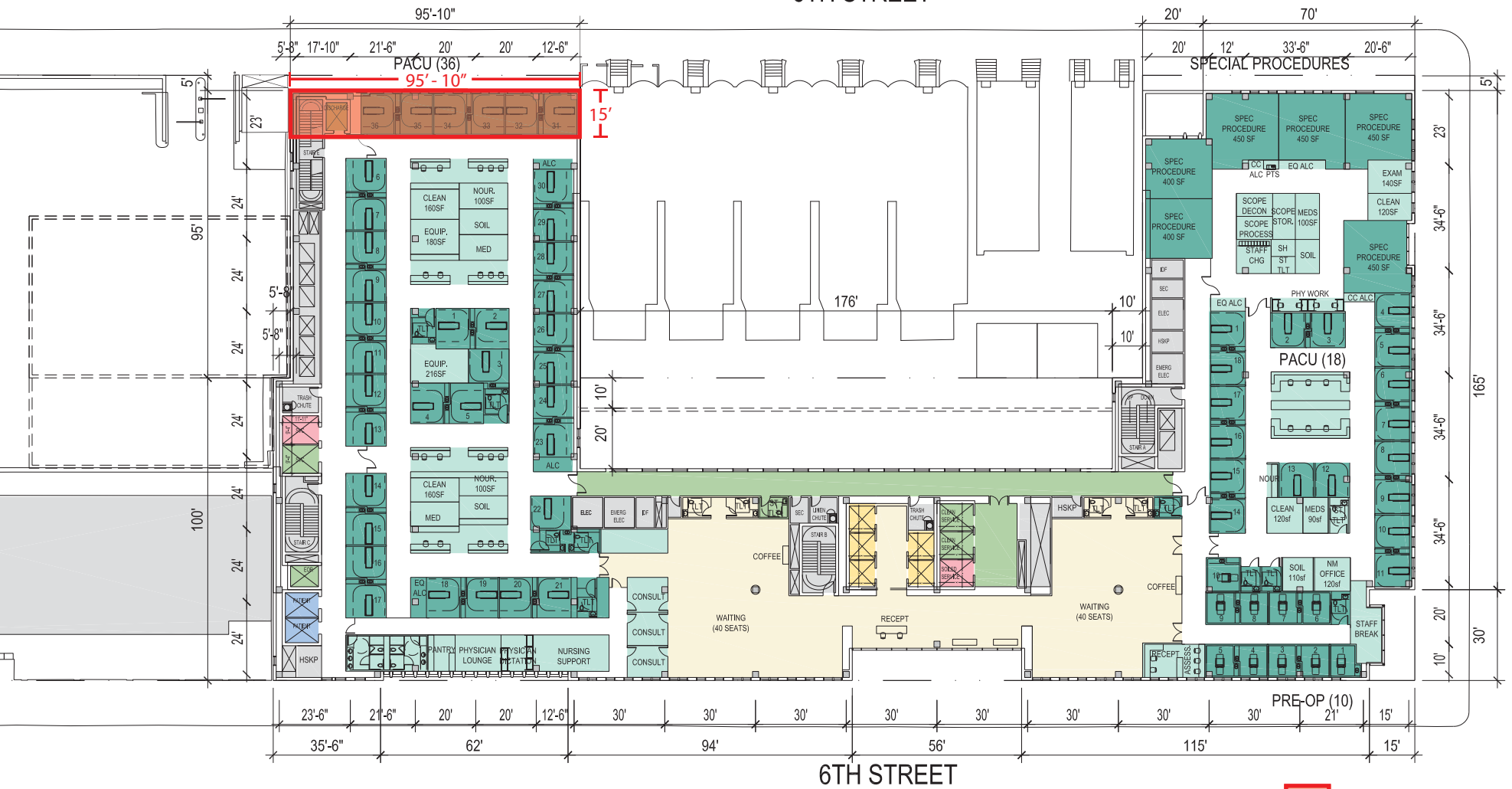

PROPOSED CHANGES

NEW YORK METHODIST HOSPITAL CENTER FOR COMMUNITY HEALTH

PROPOSED CHANGES

4TH FLOOR

APRIL 3, 2014
ILLUSTRATIVE
Perkins Eastman

5TH STREET

8TH AVENUE



 PROPOSED CHANGES

5TH STREET

8TH AVENUE

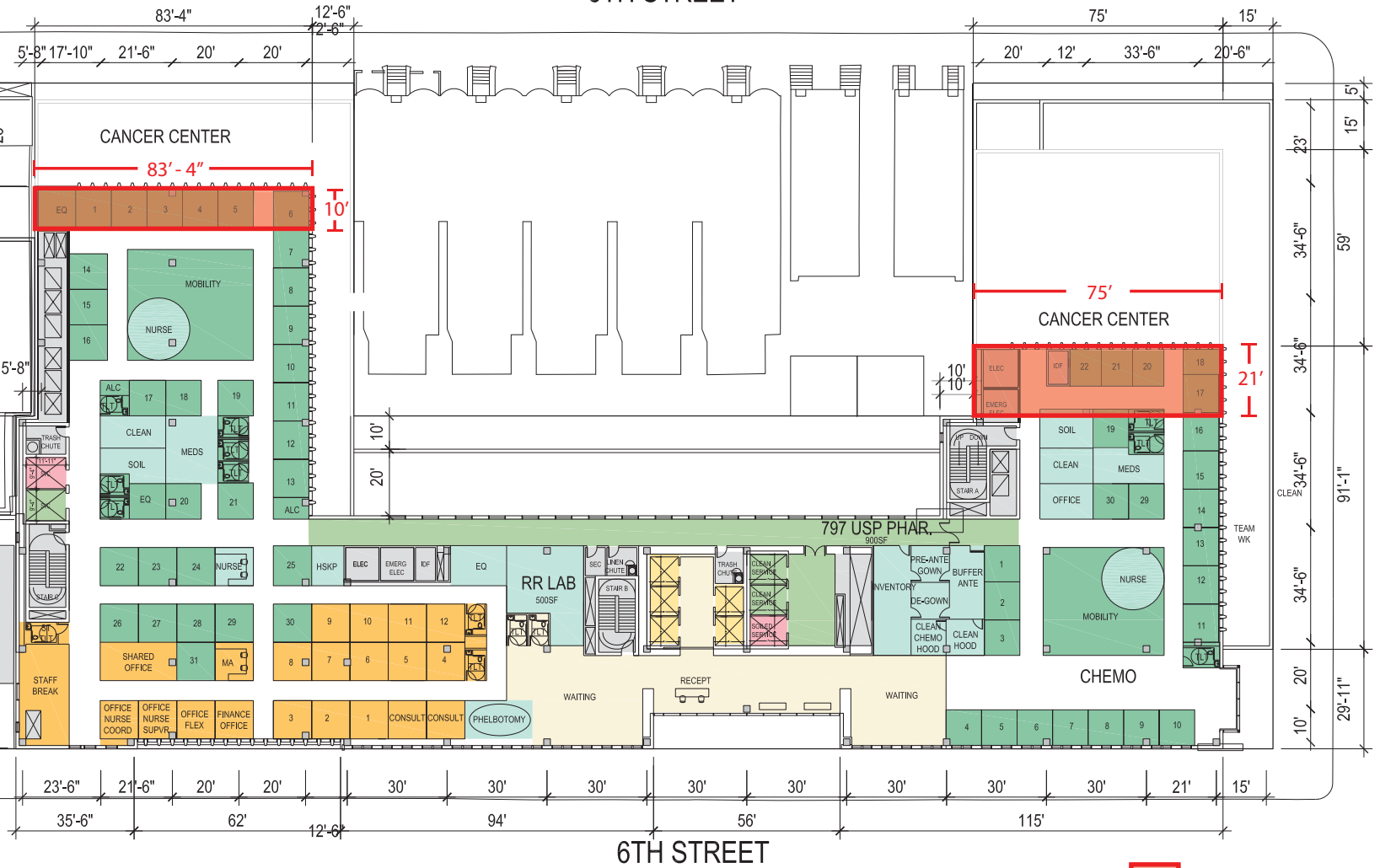

6TH STREET

5TH STREET

8TH AVENUE

6TH STREET

PROPOSED CHANGES

GREEN ROOF

83' - 4"

12'-6"

5'-8" 17'-10" 21'-6" 20' 20'

20' 12' 33'-6" 20'-6"

69'

100'

26'

23'

24'

24'

24'

24'

24'

24'

24'

24'

24'

24'

24'

24'

24'

24'

24'

24'

24'

24'

24'

24'

24'

24'

24'

24'

24'

24'

24'

24'

24'

24'

24'

24'

24'

24'

24'

24'

24'

24'

24'

24'

24'

24'

24'

24'

24'

24'

24'

24'

24'

24'

24'

24'

24'

24'

24'

24'

24'

24'

24'

24'

24'

24'

24'

24'

24'

24'

24'

24'

24'

24'

24'

24'

24'

24'

24'

24'

24'

24'

24'

24'

24'

24'

24'

24'

24'

24'

24'

24'

24'

24'

24'

24'

24'

24'

24'

24'

24'

24'

24'

24'

24'

24'

24'

24'

24'

24'

24'

24'

24'

24'

24'

24'

24'

24'

24'

24'

24'

24'

24'

24'

24'

24'

24'

24'

24'

24'

24'

24'

24'

24'

24'

24'

24'

24'

24'

24'

24'

24'

24'

24'

24'

24'

24'

24'

24'

24'

24'

24'

24'

24'

24'

24'

24'

24'

24'

24'

24'

24'

24'

24'

24'

24'

24'

24'

24'

24'

24'

24'

24'

24'

24'

24'

24'

24'

24'

24'

24'

24'

24'

24'

24'

24'

24'

24'

24'

24'

24'

24'

24'

24'

24'

24'

24'

24'

24'

24'

24'

24'

24'

24'

24'

24'

24'

24'

24'

24'

24'

24'

24'

24'

24'

24'

24'

24'

24'

24'

24'

24'

24'

24'

24'

24'

24'

24'

24'

24'

24'

24'

24'

24'

24'

24'

24'

24'

24'

24'

24'

24'

24'

24'

24'

24'

24'

24'

24'

24'

24'

24'

24'

24'

24'

24'

24'

24'

24'

24'

24'

24'

24'

24'

24'

24'

24'

24'

24'

24'

24'

24'

24'

24'

24'

24'

24'

24'

24'

24'

24'

24'

24'

24'

24'

24'

24'

24'

24'

24'

24'

24'

24'

24'

24'

24'

24'

24'

24'

24'

24'

24'

24'

24'

24'

24'

24'

24'

24'

24'

24'

24'

24'

24'

24'

24'

24'

24'

24'

24'

24'

24'

24'

24'

24'

24'

24'